

Pump Injection Accessories

**SS Quill Assemblies • 316 SS Injection Quills • Corporation Stops
Static Mixers • Valves • Quick Release Injection Tees & Manifolds**

Stainless Steel Quill Assembly

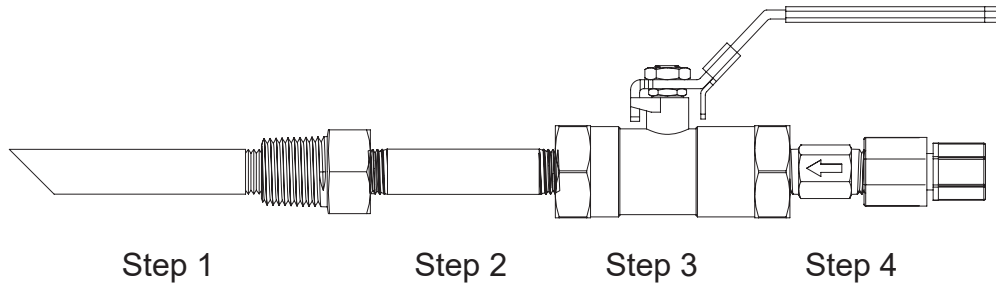

1/2" SS MNPT (1,000 PSI)

ASQ - - - -

Injection Quill Length (Step 1)

- X** = No quill
- 3** = 3" quill (1,000 PSI)
- 6** = 6" quill (1,000 PSI)
- 10** = 10" quill (1,000 PSI)

Heat Dispersion Length (Step 2)

- A** = 3" SS pipe MNPT, 1/4"
- B** = 6" SS pipe MNPT, 1/4"
- C** = 12" SS pipe, MNPT, 1/4"
- X** = No heat dispersion (only with no valve & no check or 3, 4, 6 check options)

Isolation Valve, SS (Step 3)

- X** = No valve
- 1** = 1/4" valve 300 PSI @ 300°F

Back Check and Connection (Step 4)

- X** = No check
- 1** = PVDF, Teflon, ceramic ball, dual checks, 3/8" tubing, 200°F @ 250 PSI
- 2** = PVDF, Teflon, ceramic ball, dual checks, 1/4" tubing or FNPT, 200°F @ 250 PSI
- 3** = SS, Teflon, 316 SS ball, single check, 1/4" MNPT, 440°F @ 1,000 PSI
- 4** = SS, Teflon, 316 SS ball, single check, 1/4" tubing compression, 440°F @ 1,000 PSI
- 5** = No check with 316 SS 1/4" tubing compression fitting
- 6** = SS, Teflon, 316 SS ball, single check, 3/8" tubing compression, 440°F @ 1,000 PSI

Injection Accessories

Corporation stops are for injection into larger pipes or tanks and allow removal of injector while under pressure.

Injection quills to inject chemicals into high pressure or high temperature applications like boiler water and steam lines.

Quick release PVC injection tees or manifolds for quick inspection and cleaning of pump injection assemblies.

Injection Quills

Injection quills have 1/2" NPT connections and include a built-in SS ball check and are rated to 2,000 PSI.

- A3J6** 3" quill, 316 stainless steel
- A6J6** 6" quill, 316 stainless steel

Corporation Stops

Corporation stops have 3/4" MNPT for connecting into the process pipe, and 1/2" FNPT for connecting onto the injection tube.

- ACJC** PVC Corp. stop, 125 PSI, 180°F
- ACJC4** 316 SS Corp. stop, 150 PSI, 250°F

Check Valves

- R00325** 1/4" MNPT 316 SS check valve, 440°F @ 1,000 PSI
- R00325-025** 316 SS line check with 1/4" tubing compression fitting in/out, 440°F @ 1,000 PSI
- R00325-038** 316 SS line check with 3/8" tubing compression fitting in/out, 440°F @ 1,000 PSI
- R00325-4** 1/4" MNPT x 1/4" compression, 316 SS check, 440°F @ 1,000 PSI
- 1V1E-08** 1/4" FNPT x 1/4" compression, 316 SS coupling
- 1V1E-20** 1/4" FNPT x 3/8" compression, 316 SS coupling

Advantage Controls offers a complete line of water treatment controls and feed equipment. We look forward to helping you **Get the Advantage** on all of your water treatment equipment needs.

Quick Release Injection Manifolds

Quick release injection manifolds have 3/4" slip inlet and outlet connections and a 1/2" FNPT collar for pump injection valve.

- INJ-1** 1 stage injection manifold, PVC, 3"
- INJ-2** 2 stage injection manifold, PVC, 7"
- INJ-3** 3 stage injection manifold, PVC 11"
- INJ-4** 4 stage injection manifold, PVC 15"
- INJ-11** 1" PVC slip tee assm. w/ 1/2" collar, 3 5/8"
- INJ-11-CPVC** 1" CPVC injection tee with 1/2" port
- INJ-COL** Injection collar

Static Mixers

Static mixers are made of Sch.80 120 PSI @ 125°F PVC with 3/4" FNPT union connections and a clear body.

- SM-7** 7 stage static mixer, 4.5" long, 3/4"
- SM-14** 14 stage static mixer, 9.5" long, 3/4"

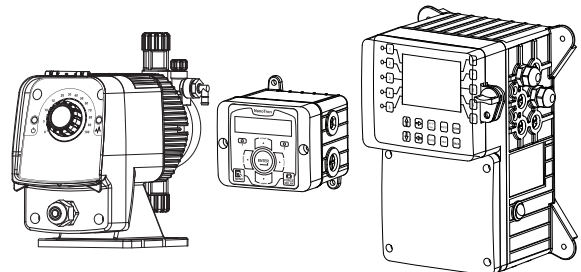

Get the Advantage