

# Flow Switches

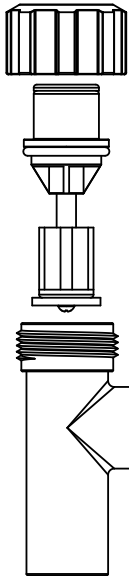

**FS-OC**

Cap and float style flow switch with 3/4" PVC tee, 140 psi @ 75°F.

Voltage (max): 30 VDC  
Current (max): 0.2 A  
Power (max): 6 watts

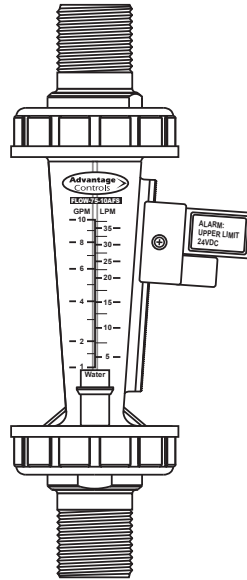

**FLOW-75-10AFS**

Flow indicator (0-10 GPM / 0-35 LPM) with adjustable flow switch, 3/4" MNPT, 7.5" long, PVC assembly, 100 PSI @ 125°F.

Voltage (max): 30 VDC  
Current (max): 0.2 A  
Power (max): 6 watts

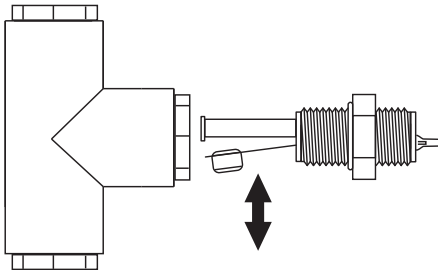

**FS-PT**

Paddle-style flow switch.

**FS-PT-075**

Switch only with 3/4" MNPT, 250 psi @ 120°F.

**FS-PT-B-075**

Switch with 3/4" brass tee.

**FS-PT-S-075**

Switch with 3/4" iron tee.

Voltage (max): 30 VDC  
Current (max): 0.1 A  
Power (max): 10 watts

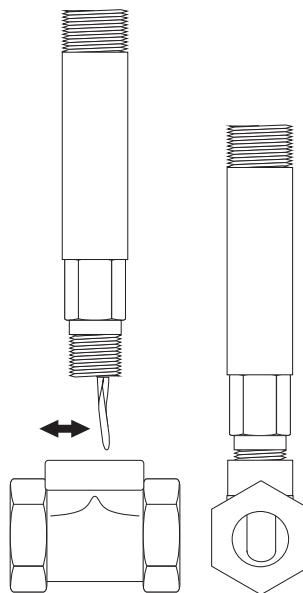

**FS-HP-075**

Paddle-style flow switch with 3/4" brass tee, 250 psi @ 220°F.

Voltage: 125/250 AC  
30 VDC  
Current: 3.0 A